

COMUNE DI ISNELLO (PA)

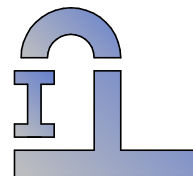

**GAL  
HASSIN**

Centro  
Internazionale  
per le Scienze  
Astronomiche  
Isello

Ing. FRANCESCO PASSANTINO  
Via Restivo Empedocle, 102  
90144 - Palermo  
Cell. 347.9962223 - Tel. 0917541028  
E-mail: ing.passantino@gmail.com

PIANO DI EMERGENZA ED EVACUAZIONE  
DELLE STRUTTURE IN USO  
DALL'ASSOCIAZIONE GAL HASSIN SITA  
IN VIA DELLA FONTANA MITRI, SNC,  
ISNELLO (PA)



IL COMMITTENTE:  
PRESIDENTE GAL HASSIN  
DOTT. GIUSEPPE MOGAVERO

ELABORATI GRAFICI

TAVOLA















EG

SCALA DISEGNI

DATA

GIUGNO 2018

## LEGENDA ANTINCENDIO

	Estintore a polvere
	Estintore a Co2
	Rilevatore di fumo
	Segnalatore ottico di fumo
	Illuminazione di sicurezza autoalimentata
	Pulsante allarme incendio
	Cassetta primo soccorso
	Pulsante interruzione alimentazione elettrica
	Quadro elettrico generale
	Quadro elettrico di zona
	Centrale rilevazione incendi
	Uscita di Emergenza
	Via di fuga orizzontale
	Punto di raccolta

# Planetario

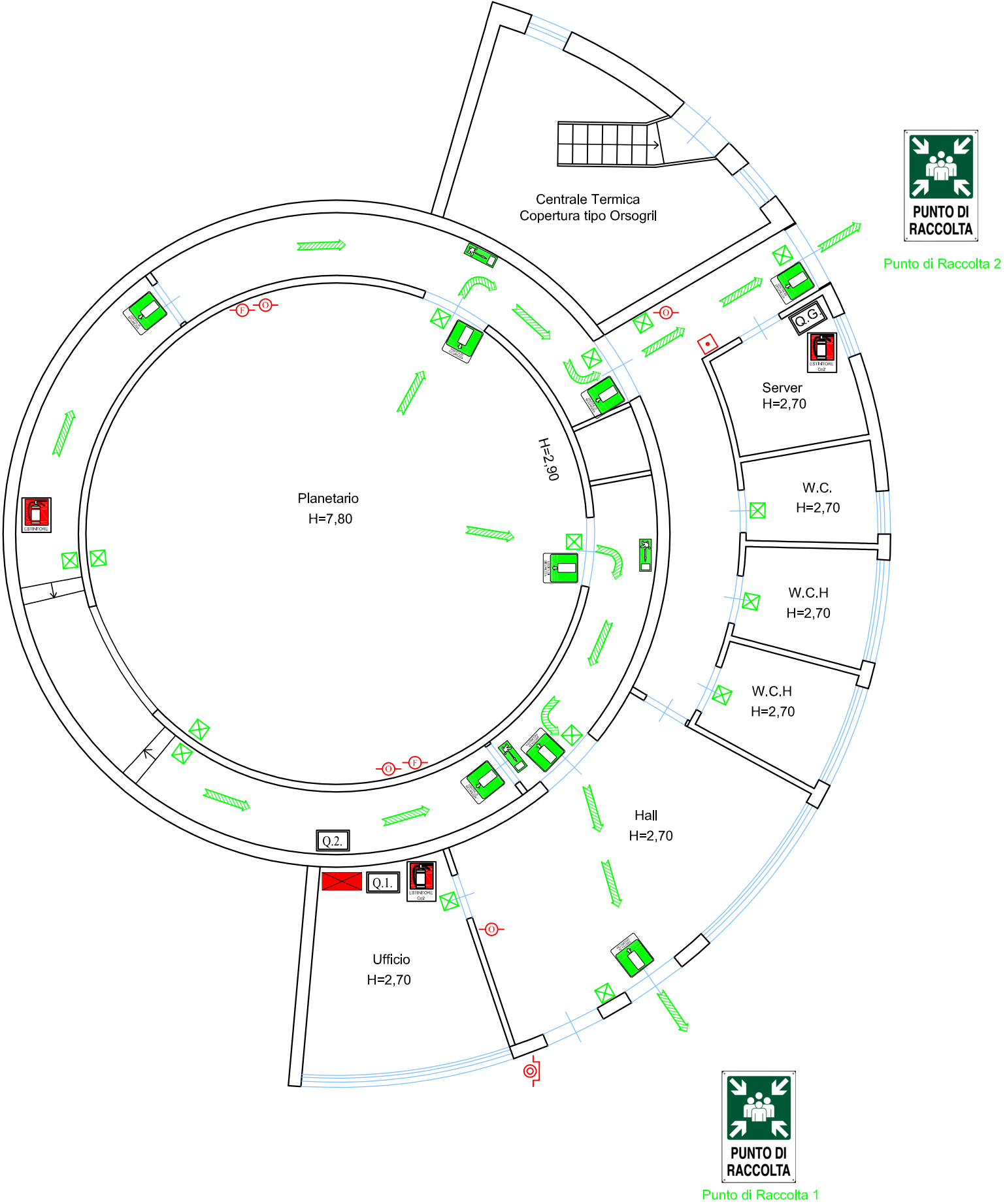

# Museo

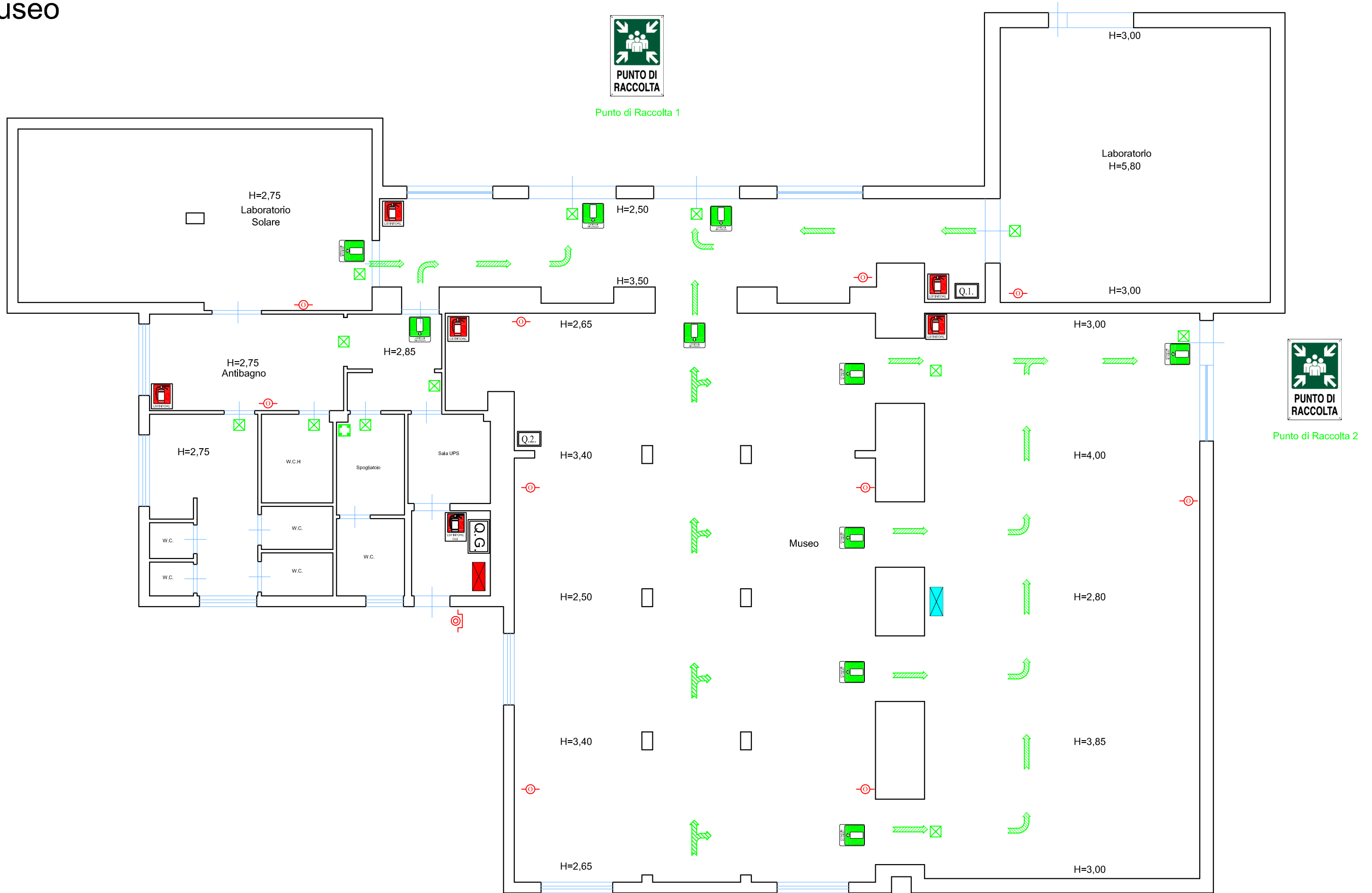

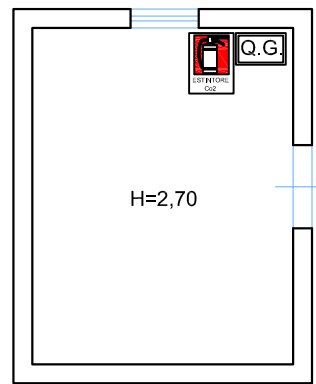

Magazzino

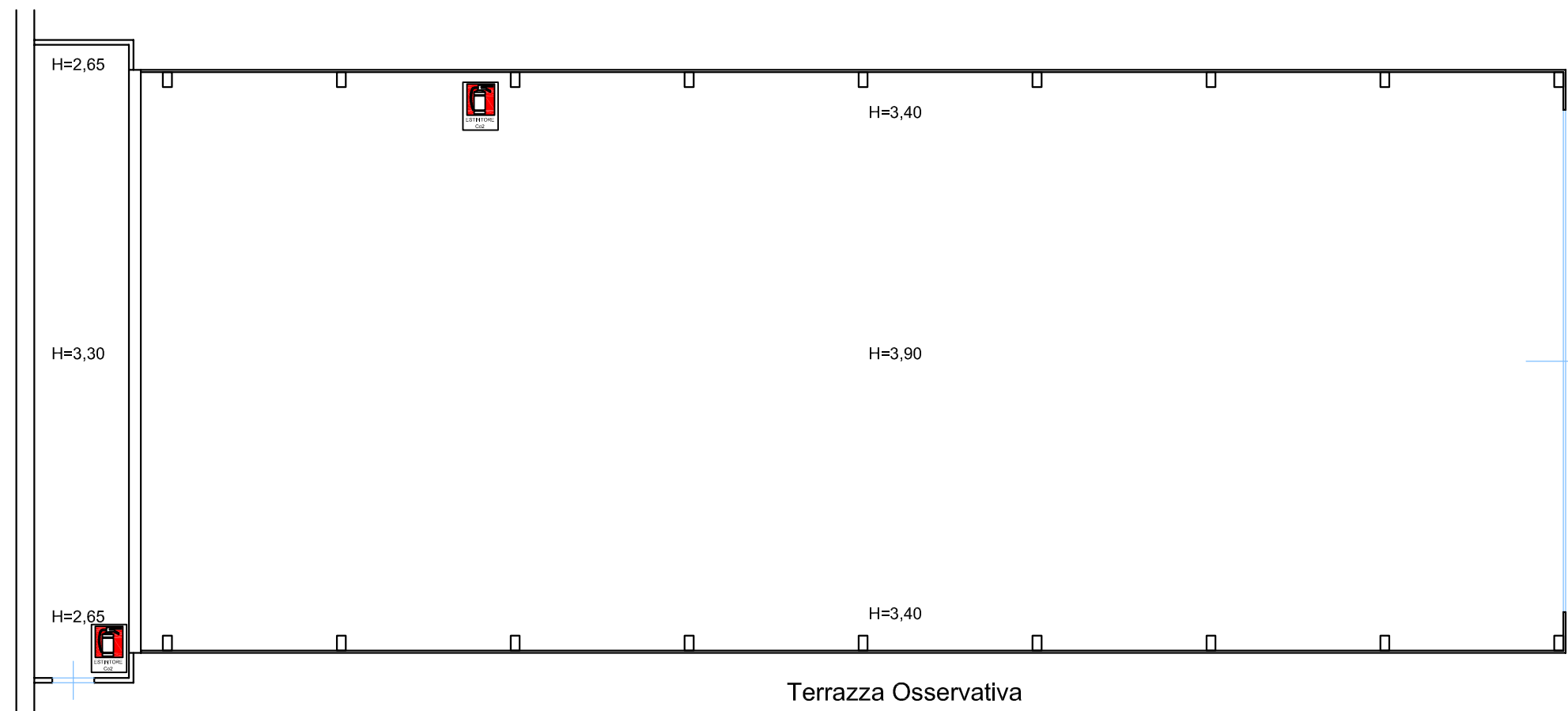

Terrazza Osservativa